



# Mounting Solution

TV Mounts/TV Stands  
/Projector Mounts

Dedicated in Mounting Solutions  
For over 14 years

[www.v-mounts.com](http://www.v-mounts.com)



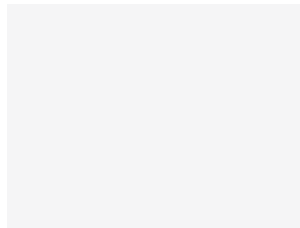

## Company Introduction

Established in early 2000, Vision Mounts is a prime manufacturer who is specialized in designing and producing a comprehensive line of Universal LED/LCD Wall Mounts, Ceiling Mounts, Projector Mounts, Desktop Mounts, TV Stands, height adjustable desks, gaming desks and electric bed frame for Audio/Video applications in home or office, including user-friendly and environmental-friendly mounting solutions.

### ■ Engineering Capabilities

We have a dedicated R&D and Engineering team to support and to serve our customer's needs.

We introduce cutting-edge designs and state-of-the-art models annually.

### ■ Production Capabilities

We serve original equipment manufacturers, institutional and industrial customers, professional installers, as well as globe and national-wide retail chains.

### ■ Quality Assurance

As an ISO9001:2000 certified manufacturer, we have implemented the Total Quality Assurance system from raw material inspection, production processing control, to final inspection and packaging. We are committed to delivering the highest quality products that are easy to install and maintain with a competitive cost saving solutions.

We have a significant amount of products are TUV certified and comply with GS regulations.

### ■ Customer-Care-Services

Our devoted customer-care-service teams always ensure that your inquiries are responded in a timely fashion and your orders are on-time delivered. Customer satisfactions are guaranteed.

# Trade Capacity

Having the right team involved from the beginning to the end of your project allows you to rest easy with the peace of mind knowing your investment and idea are in capable hands, VISION has the experience you need for successful product development from design, engineering, and manufacturing know how that brings your product quickly to life and into your customer's hands.



# The World's Major Exhibition

We focused on supplying the innovative and affordable solution for global customers.  
Simple contact us with your custom requirements. give us idea,we will give you a solution!



Hong Kong Show



Shanghai CIFF Show



China Sourcing Fair



CES Show



Guangzhou CIFF Show



Cologne, Germany Show

**Ground viewing**



**Sit viewing**



**Stand viewing**



# Gas Spring TV Mounts

Free to stop at any position.

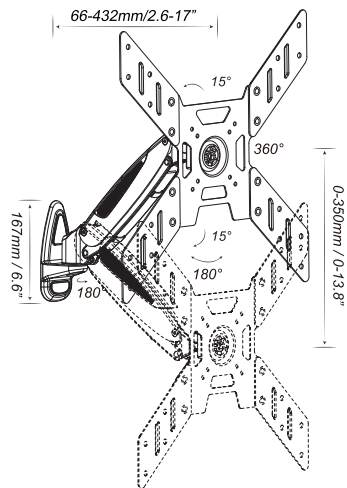
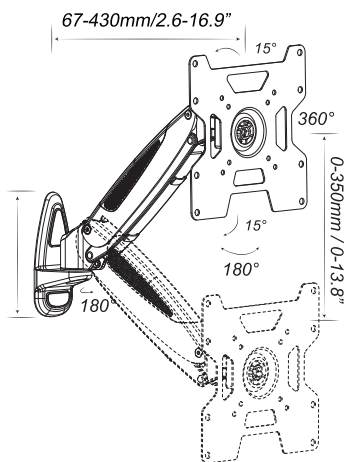

## VM-GST201

TV Size:32"-42"  
Max.load:3-16kgs/6.6-35.2lbs  
VESA 100/200

## VM-GST401

TV Size:37"-50"  
Max.load:3-16kgs/6.6-35.2lbs  
VESA 100/200/400



Height adjustable



Built-in spring tension for durability



Angle-free tilt



Cable Management

# Bracket for Curved TV

- Simple installing
- Stable support structure
- Distance to wall:83-603mm
- Angle free for tilt, swivel

## VM-CT01M



TV Size:32"-70"

Max.load:45kgs/99lbs

VESA 600x400

**HOT**



# Full Motion TV Wall Mounts

Aluminum arm, only 43 mm away from the wall.

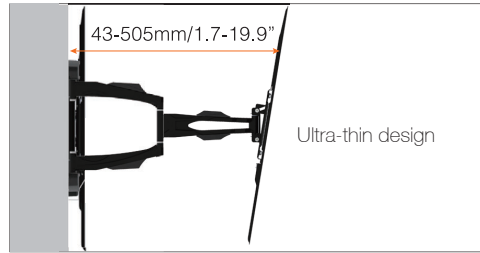

Ultra-thin design



Locking device

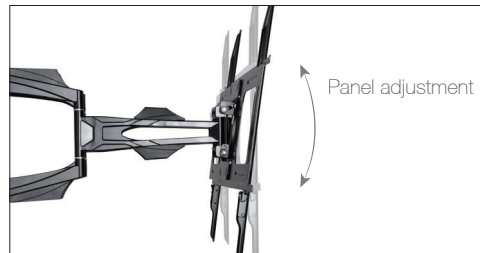

Panel adjustment

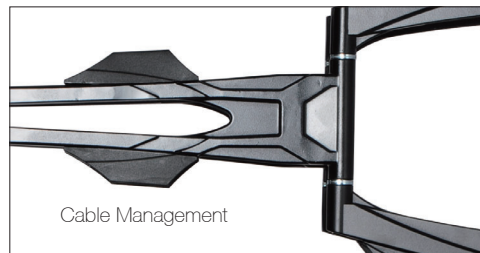

Cable Management

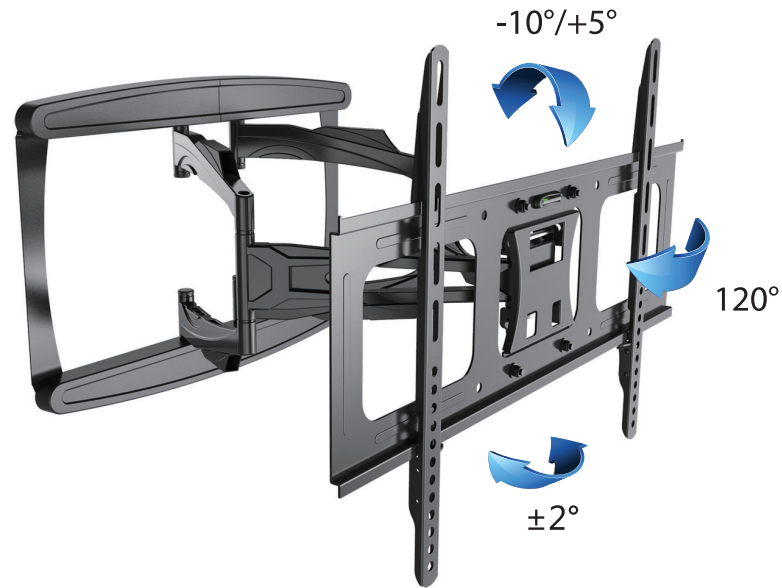

Movement ▶

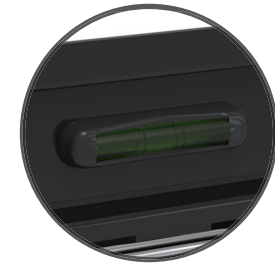

**Bubble level**

Bubble level intergrated installation is more stable

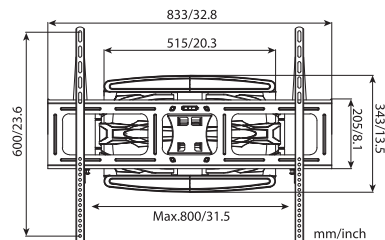

## VM-LT17

TV Size:42"-80"  
Max.load:60kgs/132lbs  
VESA 800x600

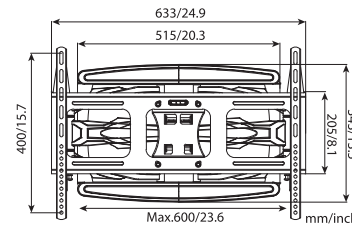

## VM-LT17M

TV Size:32"-70"  
Max.load:45kgs/99lbs  
VESA 600x400

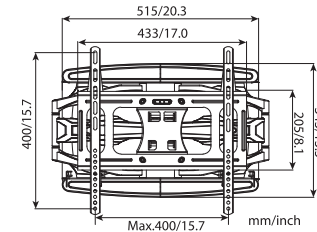

## VM-LT17S

TV Size:23"-55"  
Max.load:45kgs/99lbs  
VESA 400x400

# Full Motion TV Wall Mounts

Aluminum arm, only 43 mm away from the wall.

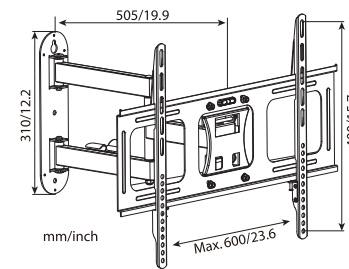
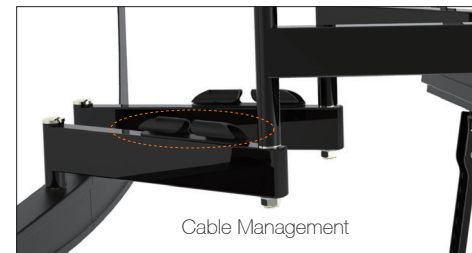
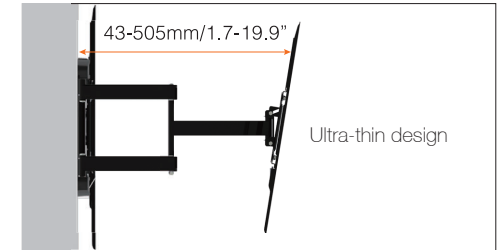

## VM-LT09M

TV Size: 32"-70"  
Max. load: 35kgs/77lbs  
VESA 600x400

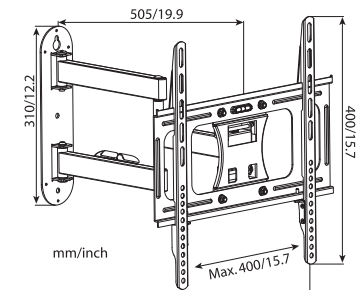

## VM-LT09S

TV Size: 23"-55"  
Max. load: 30kgs/66lbs  
VESA 400x400



# Full Motion TV Wall Mounts

Aluminum arm with streamlined design.

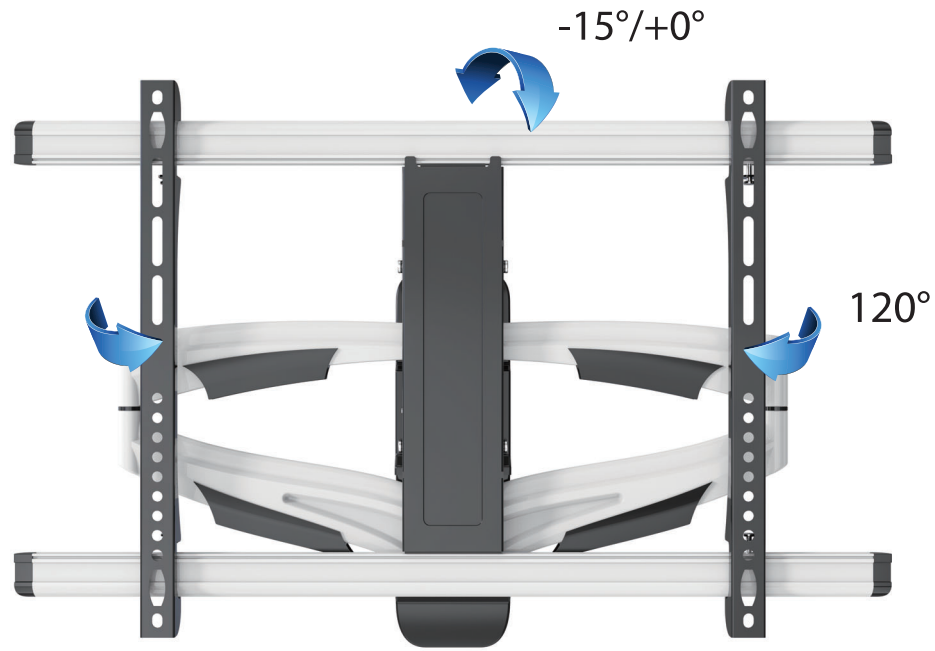

**Ultra-thin !  
Transformers.**



Movement ►

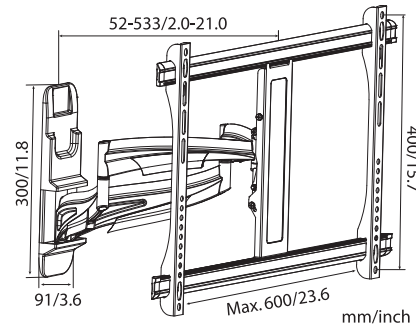

## VM-LT25M

TV Size: 32"-70"  
Max. load: 35kgs/77lbs  
VESA 600x400

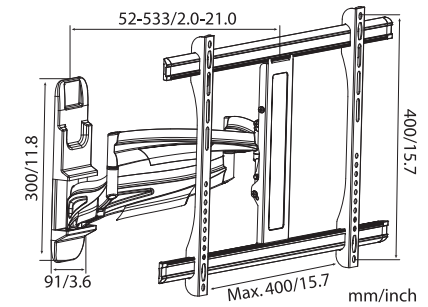

## VM-LT25S

TV Size: 23"-55"  
Max. load: 30kgs/66lbs  
VESA 400x400

# Tilting Flat Panel Wall Mounts

Iron product, only 43 mm away from the wall.

## Easy & Fast Installation

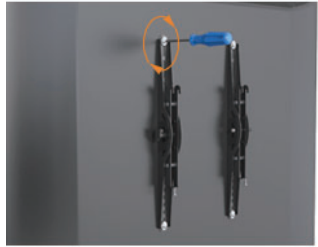

Step 1. Attach the faceplate and extender brackets to the back of your TV.



Step 2. Drill the mounting holes in your wall and then securely attach the wall plate.



Step 3. Place the TV onto the bracket and tighten.

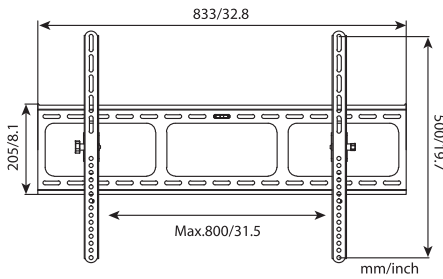

### VM-LT16



TV Size: 42"-80"

Max. load: 60kgs/132lbs

VESA 800x500

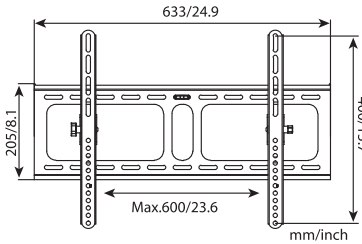

### VM-LT16M



TV Size: 32"-70"

Max. load: 45kgs/99lbs

VESA 600x400

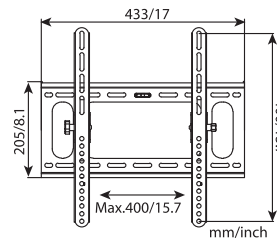

### VM-LT16S

TV Size: 23"-55"

Max. load: 35kgs/77lbs

VESA 400x400

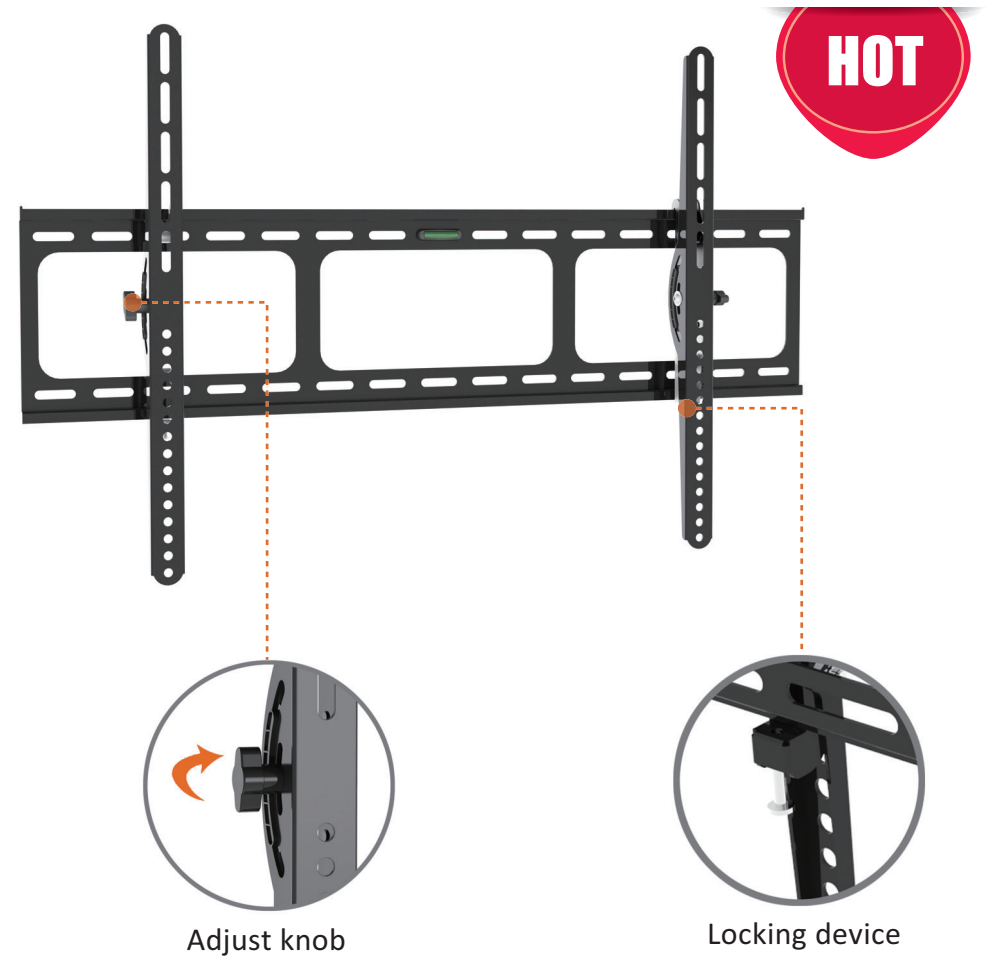

HOT

Adjust knob

Locking device

# Tilting Flat Panel Wall Mounts

Iron product, Heavy-duty TV mount.

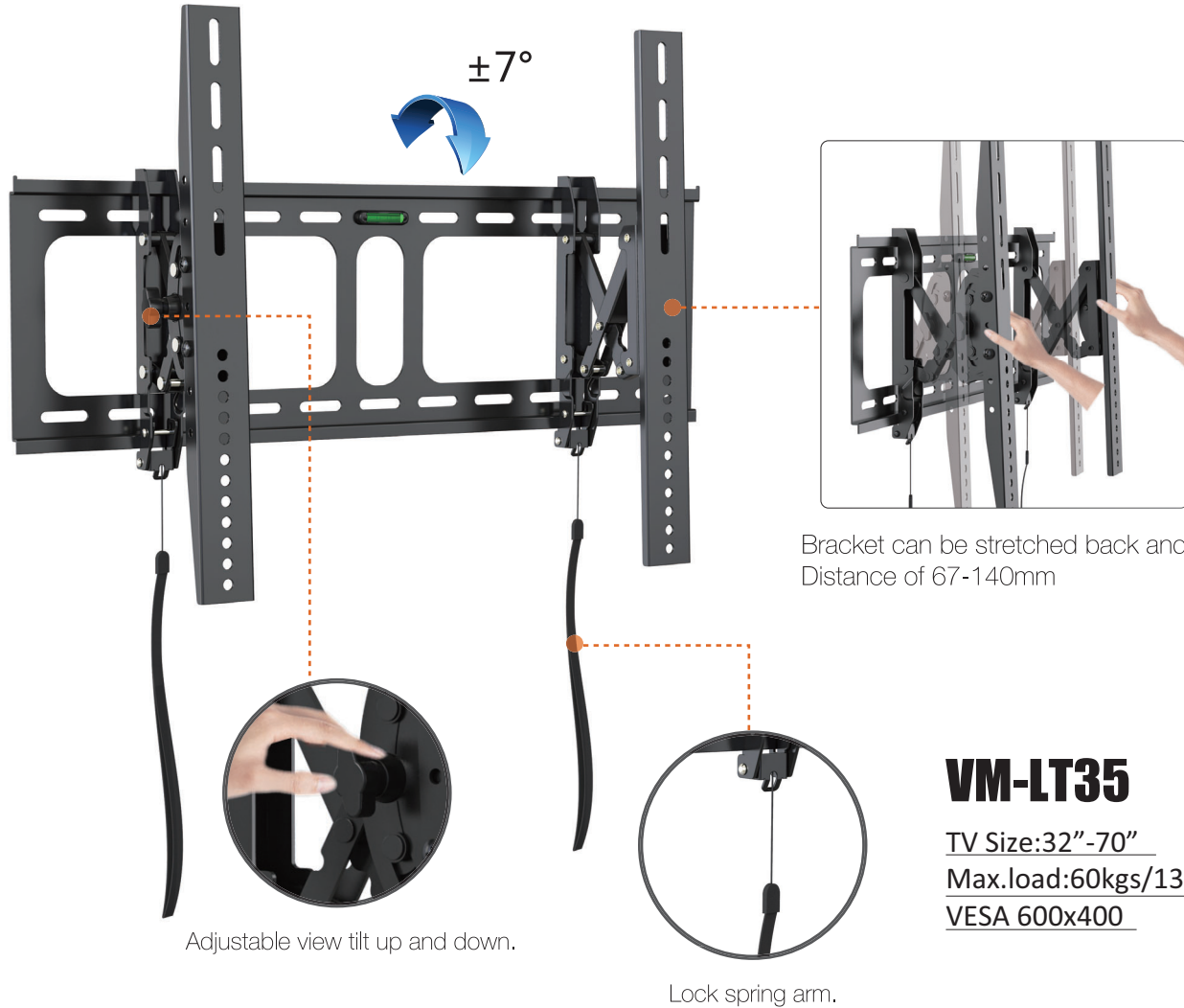

Bracket can be stretched back and forth  
Distance of 67-140mm

## VM-LT35

TV Size: 32"-70"  
Max. load: 60kgs/132lbs  
VESA 600x400

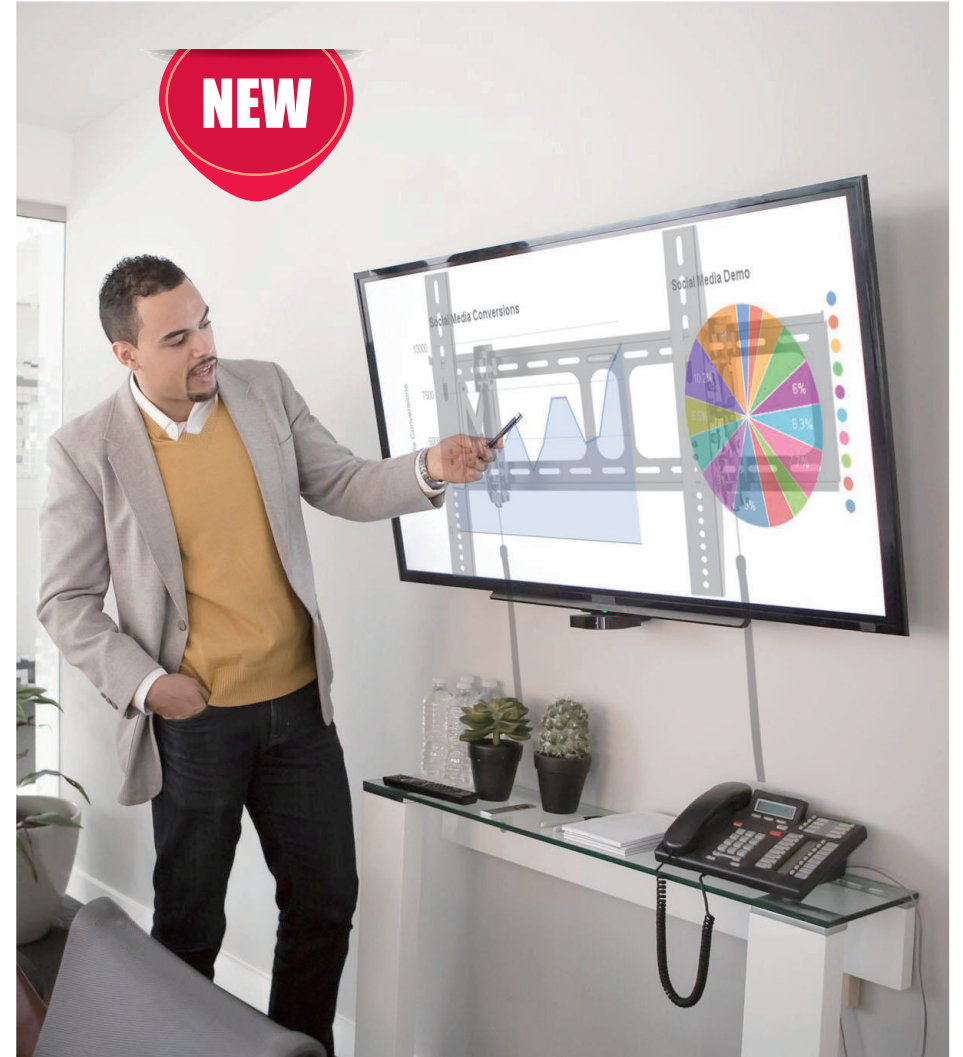

# Fixed Flat Panel Wall Mounts

Iron product, only 16 mm away from the wall.

## Easy & Fast Installation



Step 1. Attach the faceplate and extender brackets to the back of your TV.



Step 2. Drill the mounting holes in your wall and then securely attach the wall plate.



Step 3. Place the TV onto the bracket and tighten.

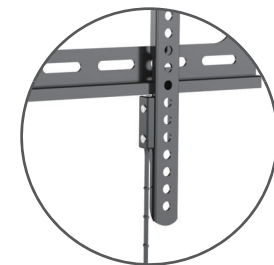
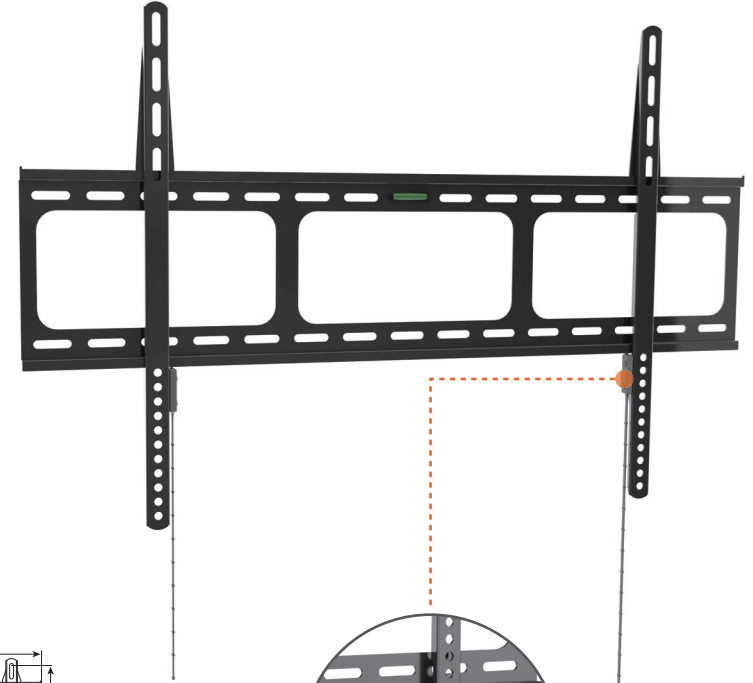

Spring lock

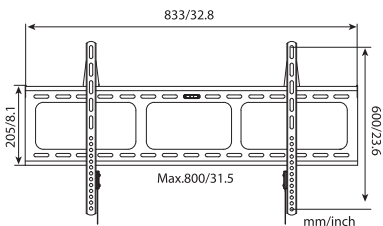

**VM-LT01**  

TV Size: 42"-100"  
Max. load: 100kgs/220lbs  
VESA 800x600

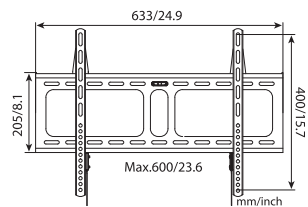

**VM-LT01M**  

TV Size: 32"-70"  
Max. load: 45kgs/99lbs  
VESA 600x400

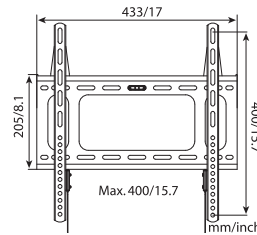

**VM-LT01A**

TV Size: 23"-55"  
Max. load: 40kgs/88lbs  
VESA 400x400

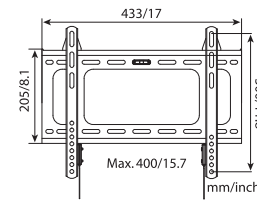

**VM-LT01S**  

TV Size: 23"-42"  
Max. load: 35kgs/77lbs  
VESA 400x300

# TV Ceiling Mounts

Iron product, height adjustable ceiling bracket.

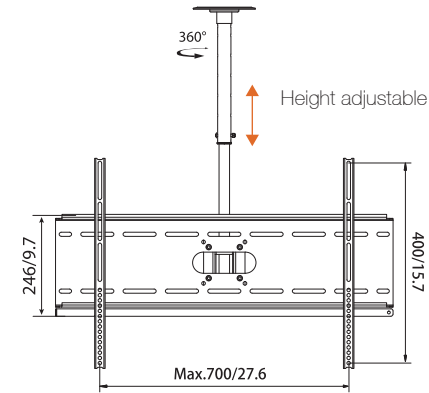

## VM-CP04-R

TV Size: 37"-70"

Max. load: 81.6kgs/180lbs

VESA 700x400

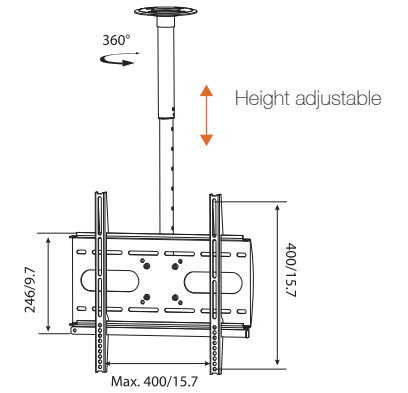

## VM-CP04S-R

TV Size: 23"-55"

Max. load: 56kgs/123lbs

VESA 400x400

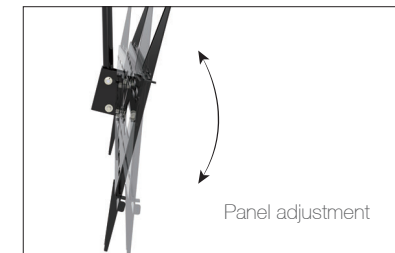

Panel adjustment



Anti-theft lock

# TV Ceiling Mounts

Iron product,height adjustable ceiling bracket.

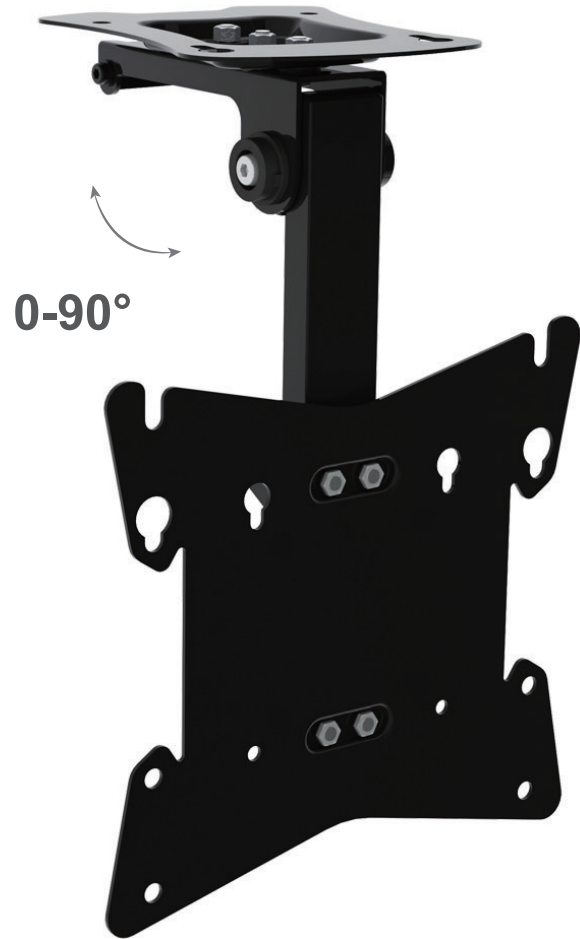

## Corner installation

Suitable for different inclined wall



## Folding design

Greater savings in your space

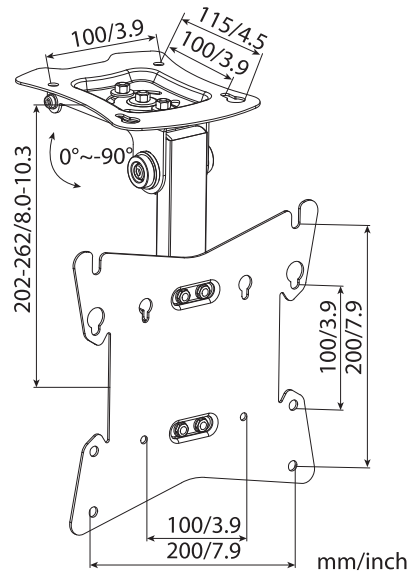

## VM-CP08

TV Size:17"-37"

Max.load:20kgs/44lbs

VESA 100/200

# TV Stand & Cart

Can be used in conference room, schools, exhibition halls, etc.



Bracket?

**NO!**  
**It's an art stand.**

## VM-AST02

TV size:45"-65"

Max load:35kg/77lbs

Dimension:1400xφ850mm

- To send out simple aesthetic ideas, direct and powerful spatial expression.
- Beech feet, wear-resistant, strong load-bearing, stable performance.
- The screen can be rotated by  $\pm 180^\circ$ , always maintaining the best viewing angle.
- The floor size is less than  $1\text{m}^2$ , and the small apartment is compatible.

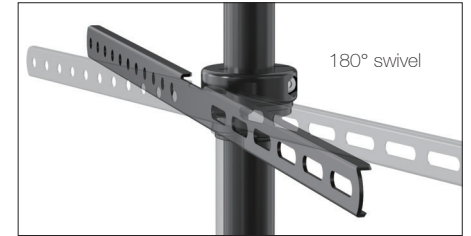

# TV Stand & Cart

Can be used in conference room, schools, exhibition halls, etc.



## VM-ST97-D

TV Size: 32"-70"

Max. load: 68kgs/150lbs

VESA 600x400

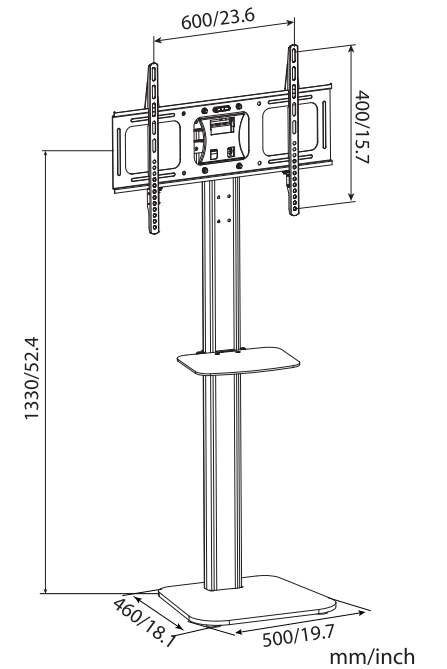
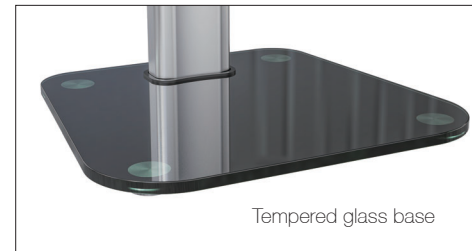
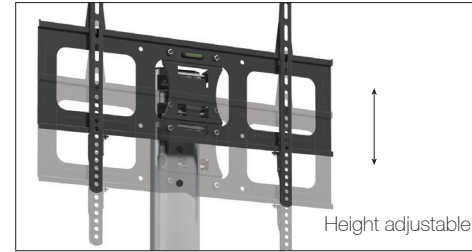



# TV Stand & Cart

Can be used in conference room, schools, exhibition halls, etc.

Can be used with  
TV cabinet renderings



## VM-ST99

TV Size: 32" - 70"

Max. load: 45kgs/99lbs

VESA 600x400

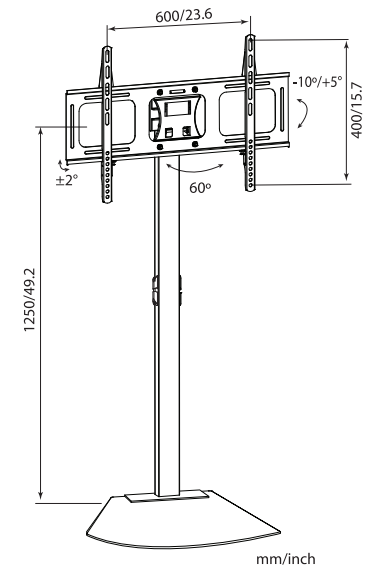
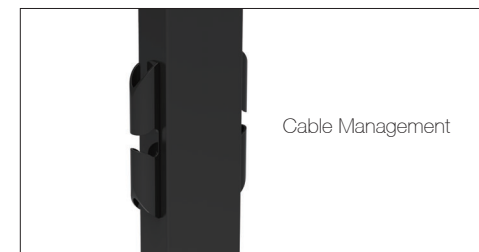
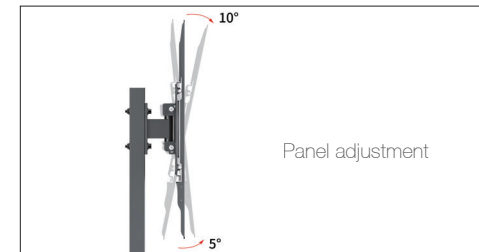

# TV Stand & Cart

Can be used in conference room, schools, exhibition halls, etc.



## VM-ST62

TV Size: 13"-27"

Max. load: 22kgs/48lbs

VESA 75/100

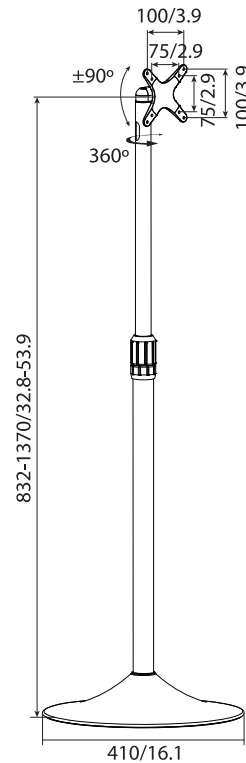

# Projector Mounts

Max load:15kg/33lbs



Both ceiling and wall can be installed.



**OR**

**VM-PR15L**

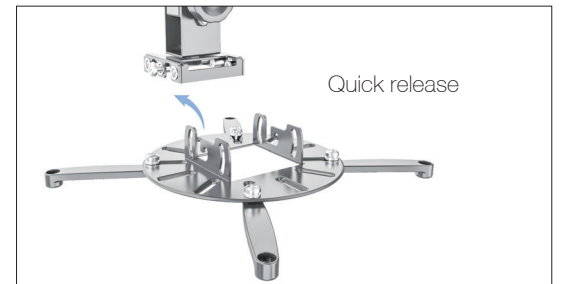
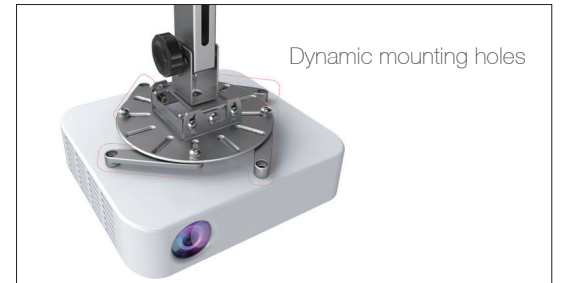
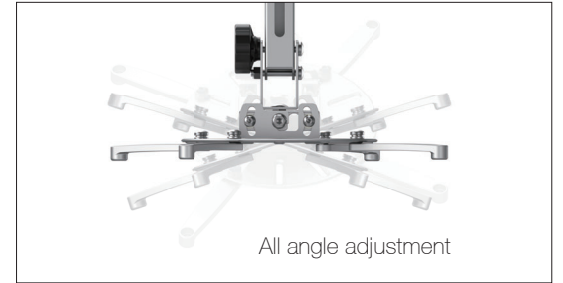

# Projector Mounts

Max load:10kg/22lbs

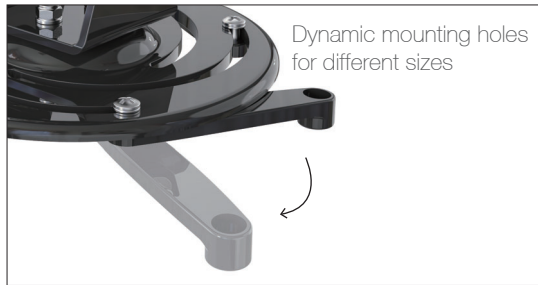

**VM-PRO1**

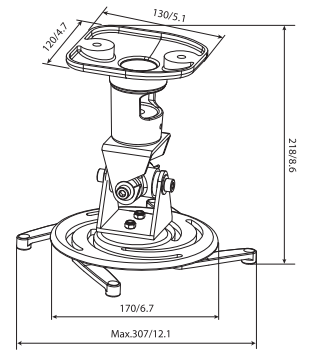
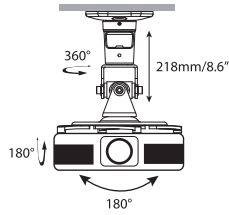

mm/inch



**VM-PRO1L**

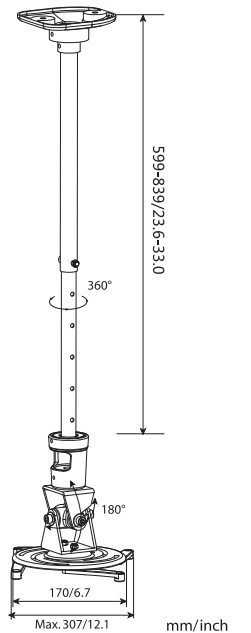
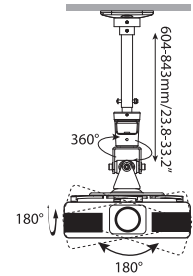

mm/inch

# Projector Mounts

Max load:15kg/33lbs

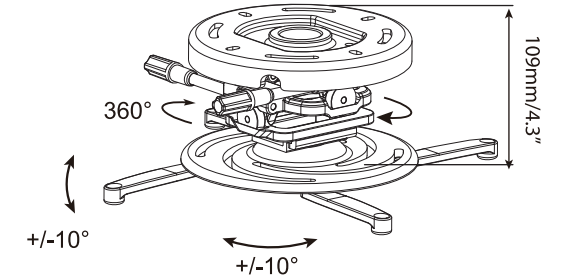
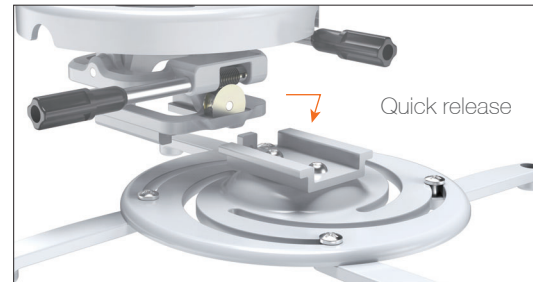
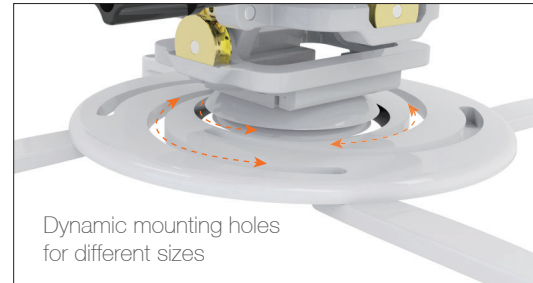
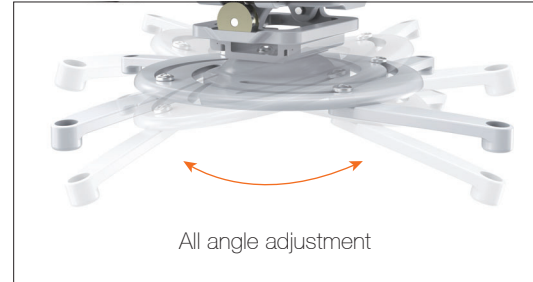

**VM-PR17**

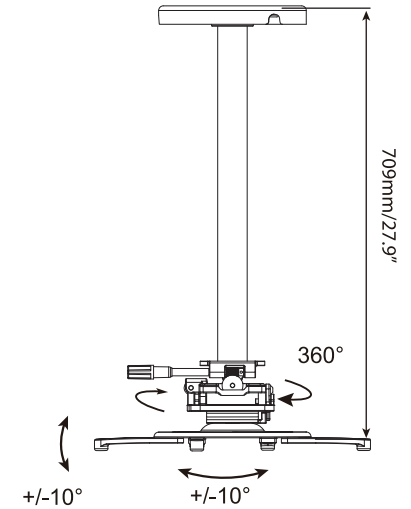

**VM-PR17L**

# Projector Mounts

Max load:10kg/22lbs

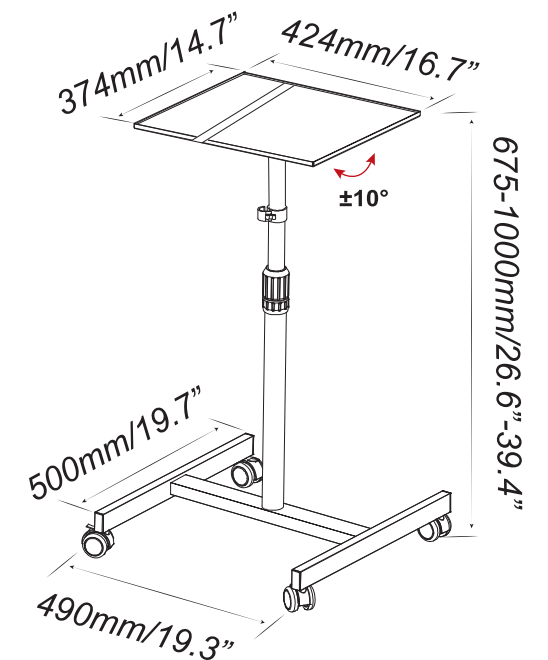

**VM-PT01**

# Ergonomic Smart Hanger

Large carrying capacity, simple assembly, compatible with small apartment.



**VM-CR01L** (Telescopic width 890-1210mm)

**VM-CR01M** (Telescopic width 660-890mm)

**VM-CR01S** (Telescopic width 510-660mm)

This smart hanger meets all width wardrobes. With all features integrated into the design, it can be adjusted to fit various requirements. In conclusion, it is truly ergonomics on the go!

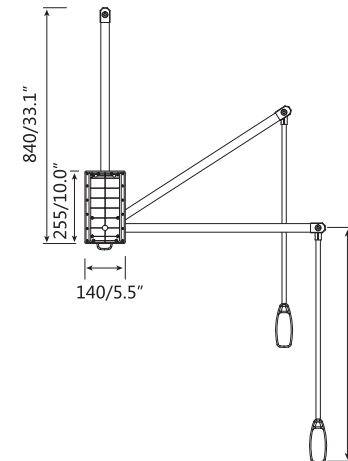
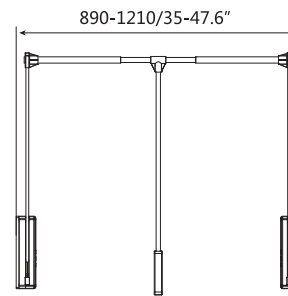



**THANK YOU !**

